

GL20X02BG

Glove Dispenser - Double



DESCRIPTION

ORIGIN™ Glove Box Dispenser – Single, Front Cut Out, ABS Beige
Accessible | Durable | Made in the USA

Holds one box of gloves with a front cut-out for fast, flap-free access in clinical, lab, or industrial environments.

Mounts easily with integrated keyholes—ideal for tight spaces or high-traffic areas.

Crafted from tough, beige ABS plastic for durability, easy cleaning, and a professional look.

Perfect for hygienic, high-efficiency workspaces.

Proudly Made in the USA – a clean, reliable glove dispensing solution.

Simplify glove access—order today!

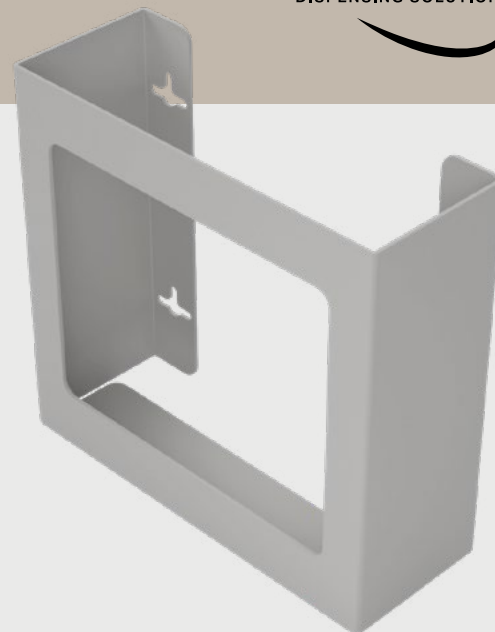

TECHNICAL DATA

Dispenses	
Main Section	Boxes of gloves up to 10.50"W x 9.90"H x 3.75"D

Specifications	
Overall Dimensions	10.70"W x 10.00"H x 3.95"D (27.2 cm x 25.4 cm x 10.0 cm)
Weight	0.9 lbs (0.4 kg) – approx.
Shipping Quantity	6 ea.
Shipping Dimensions	16.00"W x 12.00"H x 12.00"D (40.6 cm x 30.5 cm x 30.5 cm)
Shipping Weight	8.0 lbs (3.6 kg) – approx.
Material	Durable Clear PETG

USAGE AREAS

Ideal for use in healthcare, industrial, food service, and any environment where disposable gloves are required for protection and compliance.

ACCESSORIES

- N/A

FEATURES

- ✓ Holds two boxes of gloves.
- ✓ Three-way keyholes for vertical or horizontal wall or surface/pegboard mounting.
- ✓ Made in USA.

MOUNTING SPECIFICATIONS

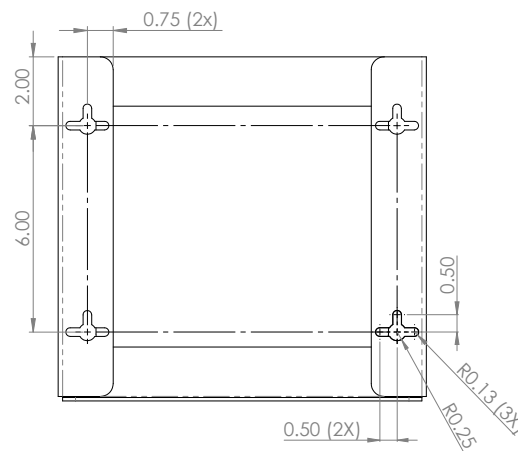

ORIGIN™ DISPENSING SOLUTIONS, LLC

Organization Begins With Us.

P: 360.912.9805

E: CustomerService@OriginDispensingSolutions.com

W: www.OriginDispensingSolutions.com

Product specifications are subject to change without notice.
Accessories and consumable items sold separately.

© 2025 ORIGIN Dispensing Solutions, LLC. All rights reserved.

GL20X02BG-TDS01