

GL24X01CL

Wall-Backed Glove Box Dispenser - Double



DESCRIPTION

ORIGIN™ Wall-Backed Glove Box Dispenser – Double, Clear PETG
Durable | Space-Saving | Made in the USA

Keep gloves clearly visible and easy to access with this double dispenser crafted from crystal-clear PETG plastic. Designed for horizontal glove box loading and vertical wall mounting, it features a full back panel for wall protection in cleanrooms, labs, or medical facilities.

Units can be stacked to streamline glove access, though boxes must be removed to reload the bottom. Lightweight, hygienic, and built to perform, this PETG dispenser is a smart upgrade for any high-efficiency space.

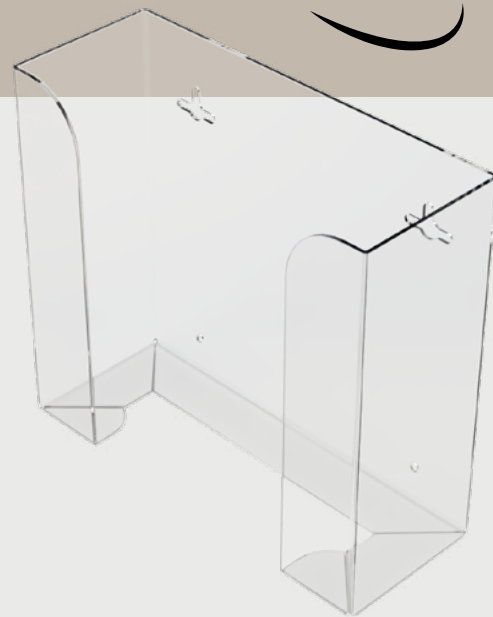

TECHNICAL DATA

Dispenses	
Main Section	Boxes of gloves up to 10.25"W x 9.40"H x 3.80"D

Specifications	
Overall Dimensions	10.45"W x 9.50"H x 4.00"D (26.5 cm x 24.1 cm x 10.2 cm)
Weight	1.2 lbs (0.5 kg) – approx.
Shipping Quantity	6 ea.
Shipping Dimensions	16.00"W x 12.00"H x 12.00"D (40.6 cm x 30.5 cm x 30.5 cm)
Shipping Weight	9.0 lbs (3.6 kg) – approx.
Material	Durable Clear PETG

USAGE AREAS

Ideal for use in healthcare, industrial, food service, and any environment where disposable gloves are required for protection and compliance.

ACCESSORIES

- N/A

FEATURES

- ✓ Holds two boxes of gloves.
- ✓ Three-way keyholes for vertical or horizontal wall or surface/pegboard mounting.
- ✓ Made in USA.

MOUNTING SPECIFICATIONS

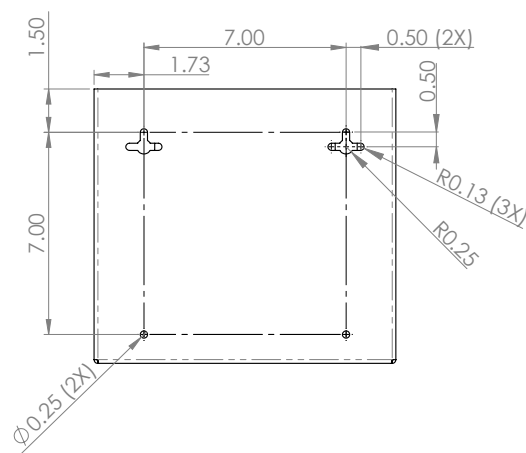

ORIGIN™ DISPENSING SOLUTIONS, LLC

Organization Begins With Us.

P: 360.912.9805

E: CustomerService@OriginDispensingSolutions.com

W: www.OriginDispensingSolutions.com

Product specifications are subject to change without notice.
Accessories and consumable items sold separately.

© 2025 ORIGIN Dispensing Solutions, LLC. All rights reserved.

GL24X01CL-TDS01